

# MattMill Braumeister System

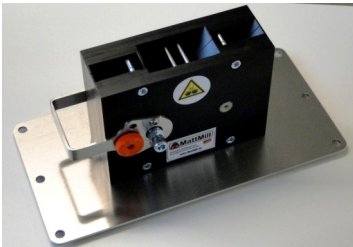

Modular High-End system for ambitious home brewers and microbreweries:

**MattMill Braumeister (MMBR)**  
or  
**MattMill Braumeister 230V (MMBR MOT)**  
and  
**MattMill Braumeister Trichter (MMBR TR)**  
**MattMill Braumeister Ständerwerk (MMBR ST)**



**MMBR:** specially designed for circulation pump systems

- plasma-hardened steel rollers (Ø 70 mm), cut-knurled for maximal sharpness and durability
- milling gap fool safe and quickly adjustable in five steps 1,15-1,65mm
- integrated protection
- maintenance-free bearings
- solid high-tec chassis, food grade
- solid stainless steel base plate
- to be driven slightly with hand crank, cordless screwdriver or as MMBR MOT version incl. powerful 230V Motor drive

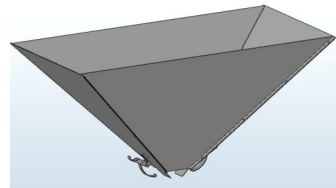
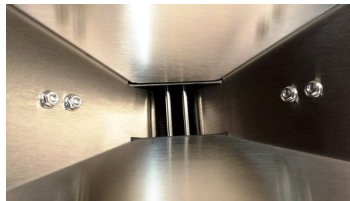
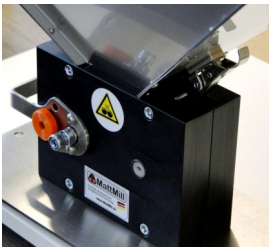

**MMBR TR** Stainless steel funnel 25L Volume, safe, tool free mounting



**MMBR MOT:** MMBR incl. ready for plug in, powerful 230V-Motor drive, 93/min for appr. 54kg/h highest quality crush. 12kg heavy duty german engineering and craftsmanship!

**MMBR ST:** heavy, solid stand, fixed on the table or to the wall, or mobile. Stainless steel consoles (high adjustable 150-500mm)